

PT-OL-A-0/ PT-OL-A-1/ PT-OL-A-2 Series

Comply with SIL2 safety performance standard
Magnetic zero locally and Auto-Zero remotely
Alloy filling & Mercury filling is optional



Certification :

ISO9001-2015



Content

1. Introduction _____
2. Application _____
3. Product Features _____
4. Technical data _____
5. Dimensions _____
6. Electrical connection and debugging _____
7. Ordering Guide _____
8. Installation and Removal _____
9. Sensors cleaning _____
10. Transport and Storage _____

1. Introduction

PT-OL-A-0 / PT-OL-A-1 / PT-OL-A-2 series adopt high-performance core components, digital-analog integrated circuit design, linear compensation can be achieved through the program, and high measurement accuracy can be obtained. Comply with SIL2 safety performance standards. This series can be rezeroed in two ways:remotely via shorting two pins together and locally via magnetic contacts.

2. Application

It is used for the control of the extrusion process of clean materials such as sheets, composite materials, films, pipes, food packaging, medical packaging, etc..

3. Product Features

Remotely autozero and locally magnetic zero
80% Internal calibration
Mercury free filling and relay output is optional



4. Technical Data

Characteristic

Power Supply	mV/V: 10 V DC(recommended), mA or V : 24V DC
Signal Output	3.33mV/V, 0-5V, 0-10V or 4-20mA
Accuracy	±0.25% FS, ±0.5% FS, ±1% FS
Repeatability	±0.2% FS
Working Temperature	mV/V, mA: 185° F (85°c)
Overload Ability	2x FS
Pressure Range	0-35 Bar---2000Bar
Pressure Unit	psi, Bar, kPa or MPa
Zero Adjustment	mV/V: No, mA: ± 20%
Zero Balance	mV/V: ± 10%: mA: ± 0.5%
Zero Drift (caused by progress)	1.5bar/100° F(3bar/100°)
Bridge Resistance	mV/V: 345 Ω, at least
Overload	mA: 1100 Ω, at most
Insulation Resistance	mV/V: 1000MΩ @50 Vdc mA: 100M Ω @50 Vdc
Shunt Calibration	80% FS ± 1% FS

Mechanical and Sealing Characteristics

Transducer Technology	Bonded Wheatstone and Wheatstone bridge
Diaphragm Temperature	750° F(400°C), at most
Diaphragm Materials	5 Different Diaphragm Options
Progress Connection	1/2 – 20 UNF and M14 × 1.5, M16 × 1.5, M18 × 1.5 Thread
E – connection	5 PIN,6 PIN,7 PIN,8 PIN
Install Torque	500 in/lbs , at most
Temperature Transducer (optional)	E/J/K/PT100 Type Thermocouple Matches With
Certification	Patented
Certification	CE Certified
Recommend Fitting	
Install Tools	Component GJ
6 Pin E – connection	Component CON06
Matching Connection	
Fix Frame (electric device)	Spares No.:ZJ, cable Fitting, indicator

5. Dimensions

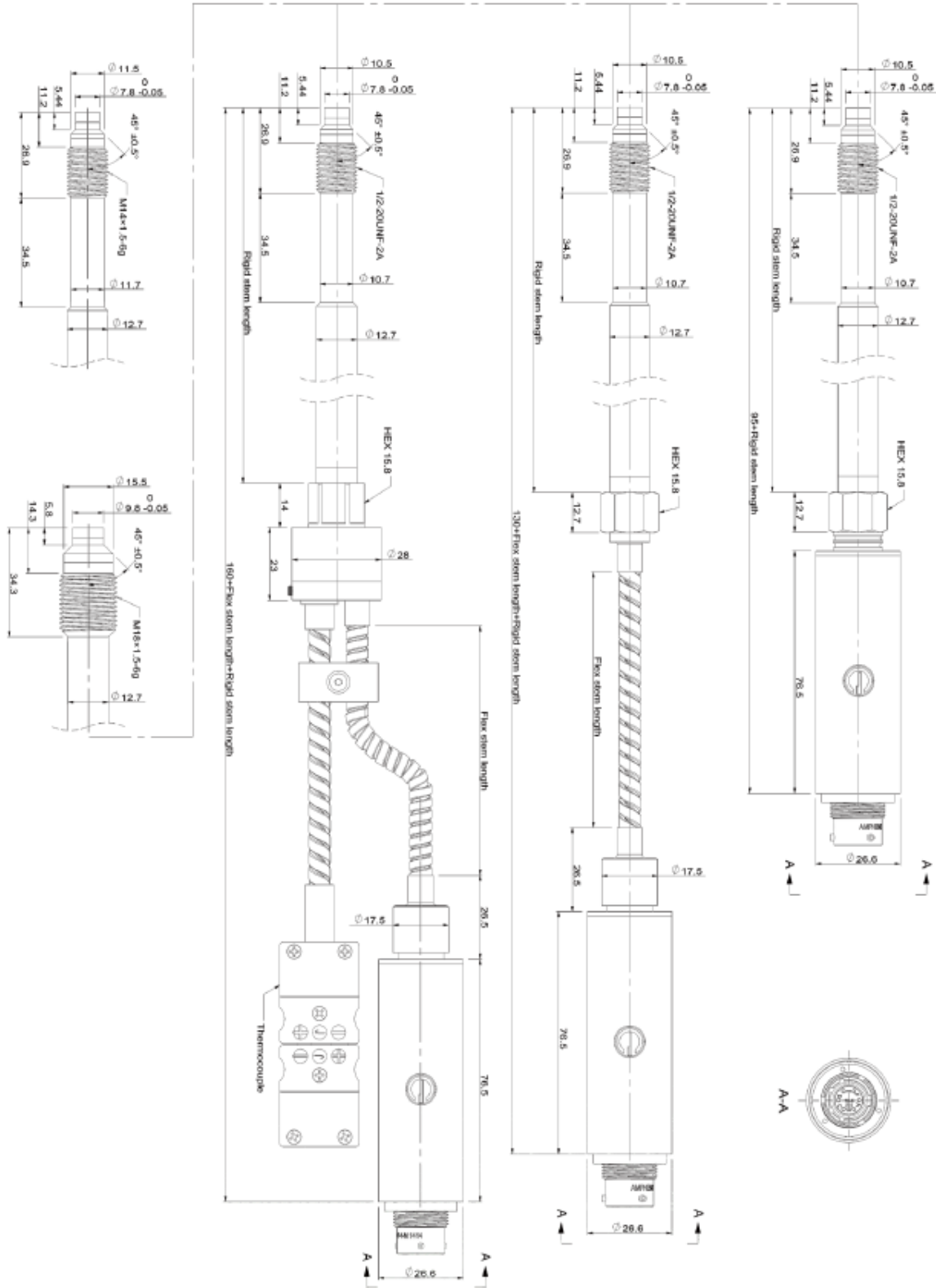

6. Electrical connection & Debugging

After the pressure sensor has been installed on the pipeline, the electrical connection must be carried out in accordance with the connection mode shown in the wiring diagram below. PT-AL series is equipped with an integrated amplifier circuit. The calibration process must be that the pipeline is heated and the pressure is zero. The zero point is adjusted by activating the autozero function, which is via shorting two pins to start (refer diagram below) or magnetic pen. Then 80% of the output signal is detected (see wiring diagram), and the pressure sensor will provide a standard 80% measured value signal.

Rezero with Magnetic Pen



3.33 mV/V Output (4-wire)

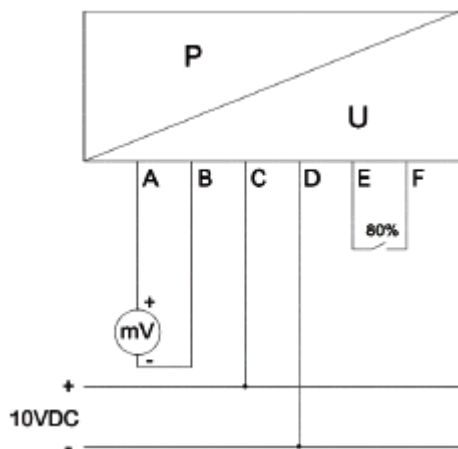

6-pin Connector / PT02A - 10- 6P

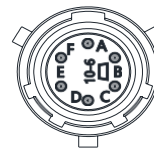

PIN	Function	Wire Color
A	Signal +	Red
B	Signal -	Black
C	Power +	White
D	Power -	Green
E	80% +	Blue
F	80% -	Orange

4 – 20mA Output (2-wire)

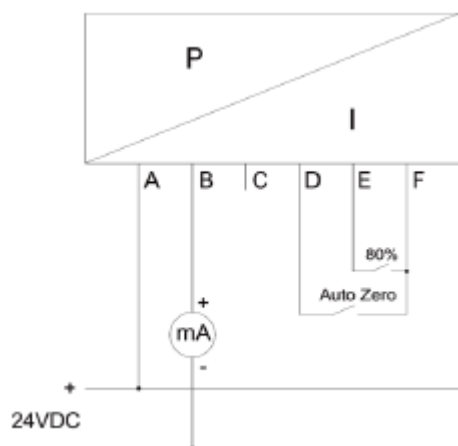

6-pin Connector / PT02A- 10- 6P

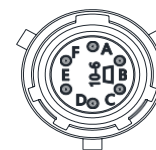

PIN	Function	Wire Color
A	Power +	Red
B	Power -	Black
C		White
D	Shorting D&F to rezero +	Green
E	80% +	Blue
F	Shorting D&F to rezero - /80% -	Orange

0 - 5V / 0 - 10V (4-wire)

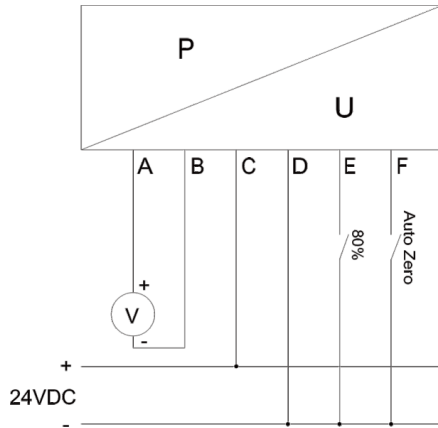

6-pin connector / PT02A-10-6P.



PIN	Function	Wire Color
A	Signal +	Red
B	Signal -	Black
C	Power +	White
D	Power - / 80% - / Shorting D&F to rezero	Green
E	80% +	Blue
F	Shorting D&F to rezero - /80% +	Orange

* B and D pins are connected internally.

It must be a shielded cable, each core wire is about 0.3 mm², the heat-resistant temperature is not less than 105 C°, each core wire connection terminal should be insulated and protected by heat shrinkable tube, the shielding wire should be connected with the plug-in metal, and the cable should be specially welded carefully, otherwise it may cause signal transmission errors or damage the product. It is recommended to use a dedicated cable that has been soldered by MPS. For extra wires in the cable, each wire needs to be individually wrapped with insulating tape.

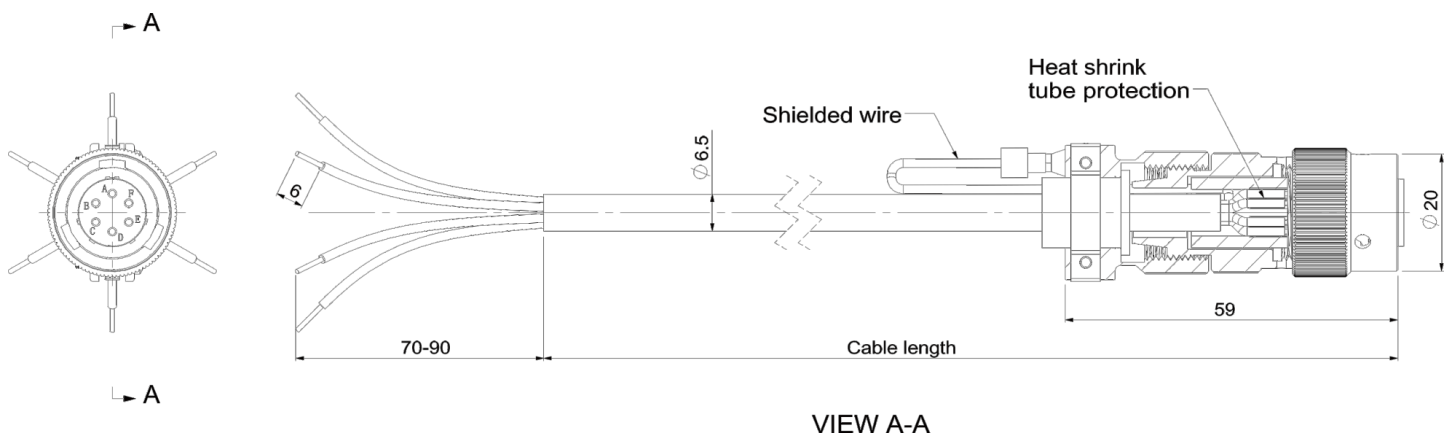

7. Installation & Removal

Installation

When installing the pressure sensor, the sensor hole should be within the size requirement marked in following drawing and the assembly accuracy can be checked by testing bolts. Before installing the sensor, first clean the impurities in the hole and between the threads, then the thread of the sensor is coated with heat-resistant slurry, the screw teeth can be avoided.

The installation force is very important, the installation torque of the sensor can only act on the shaft (hexagon), do not apply any force to the head of the sensor. The housing should be kept away from high temperature areas.

1/2–20 UNF /M14×1.5= Maximum starting torque: 40Nm

M18 x 1.5 = Maximum starting torque: 50 Nm

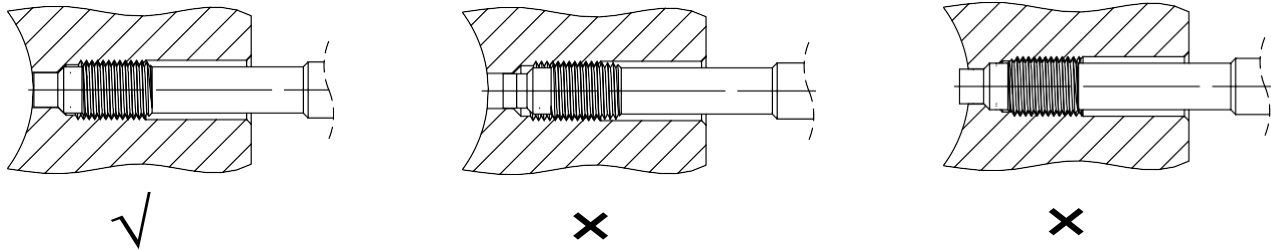

Removal

The removal of sensor must be done under heated conditions (plastic melting point). When remove the sensor, please note that the diaphragm has no contact pressure. The force to remove the sensor must only be applied on the shaft (hexagon), and do not apply any force to the head of the sensor.

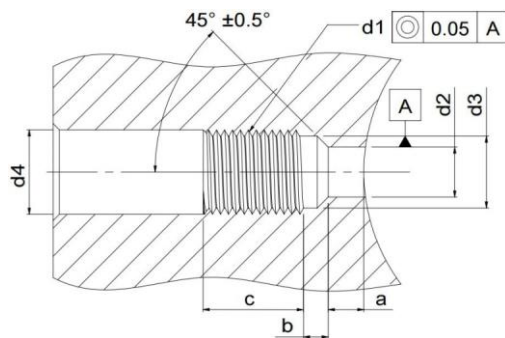

d1	M18×1.5	M14×1.5	1/2-20UNF-2A
d2	Ø9.9 ^{+0.1}	Ø7.9 ^{+0.1}	Ø7.9 ^{+0.1}
d3	Ø16.1 ^{+0.1}	Ø11.7 ^{+0.1}	Ø10.7 ^{+0.1}
d4	Ø20	Ø15	Ø14
a	6.1 ^{-0.1}	5.7 ^{-0.1}	5.7 ^{-0.1}
b	4 ^{-0.2}	3.2 ^{-0.2}	3.2 ^{-0.2}
c	25	19	19

8. Sensors cleaning

In order to clean the diaphragm, the sealing surface and thread of the sensor must have the same temperature as the melting point of the plastic. Both the diaphragm and the sealing surface can be wiped clean with a soft cloth, and the thread can be cleaned with a steel brush or a copper brush. . (Do not touch the surface of the diaphragm with the steel brush)

9. Transport and storage

The PT-OL-A-0 / PT-OL-A-1 / PT-OL-A-2 series is usually packaged separately. The front thread of the rigid stem and the diaphragm is protected by a protective cap. This protective cap should be tightened at any time during storage, and only opened during installation.

Notes: Mounting brackets,extension cables,connectors,cleaning kits,drill kits,dummy plug etc accessories,please contact with us.

10. RECOMMENDED ACCESSORIES

<p>Pressure indicators & Pressure controllers are available for mated sensors to display and to control the pressure and for further transmission.</p>	
<p>Drilling tool kits. Drilling tool kits include all of necessary drills and taps to prepare a standard transducer mounting holes and contains the special pilot drill required to machine the 45 degree seat. Kits are available for all thread ranges of 1/2"-20UNF, M14x1.5, M18x1.5, M22x1.5 etc.</p>	
<p>Cleaning tool kits. Cleaning tool kits are designed for removing the plastic debris from the mounting hole for melt pressure and temperature sensors to keep from damaging by improperly cleaned holes. Kits are available for all thread ranges of 1/2"-20UNF, M14x1.5, M18x1.5, M22x1.5 etc.</p>	
<p>Simulators. It can be substituted for pressure transducer with mV/V output to simplify the on-line troubleshooting.</p>	
<p>Pressure transducer converter. Convertors are designed to convert mV/V signal to amplified signal mA or Voltage.</p>	
<p>Connectors and cables. Extension cables assemble a sensor mating connector with stripped leads. The connectors are available with 5pin, 6pin, 7pin and 8pin for mated sensors.</p>	